

FLOOR PLAN (1:100)

GROUND STOREY = 109,7sq.m.
 SERVANT'S ROOM = 13,7sq.m.
 TOTAL GROUND STOREY = 123,4sq.m.

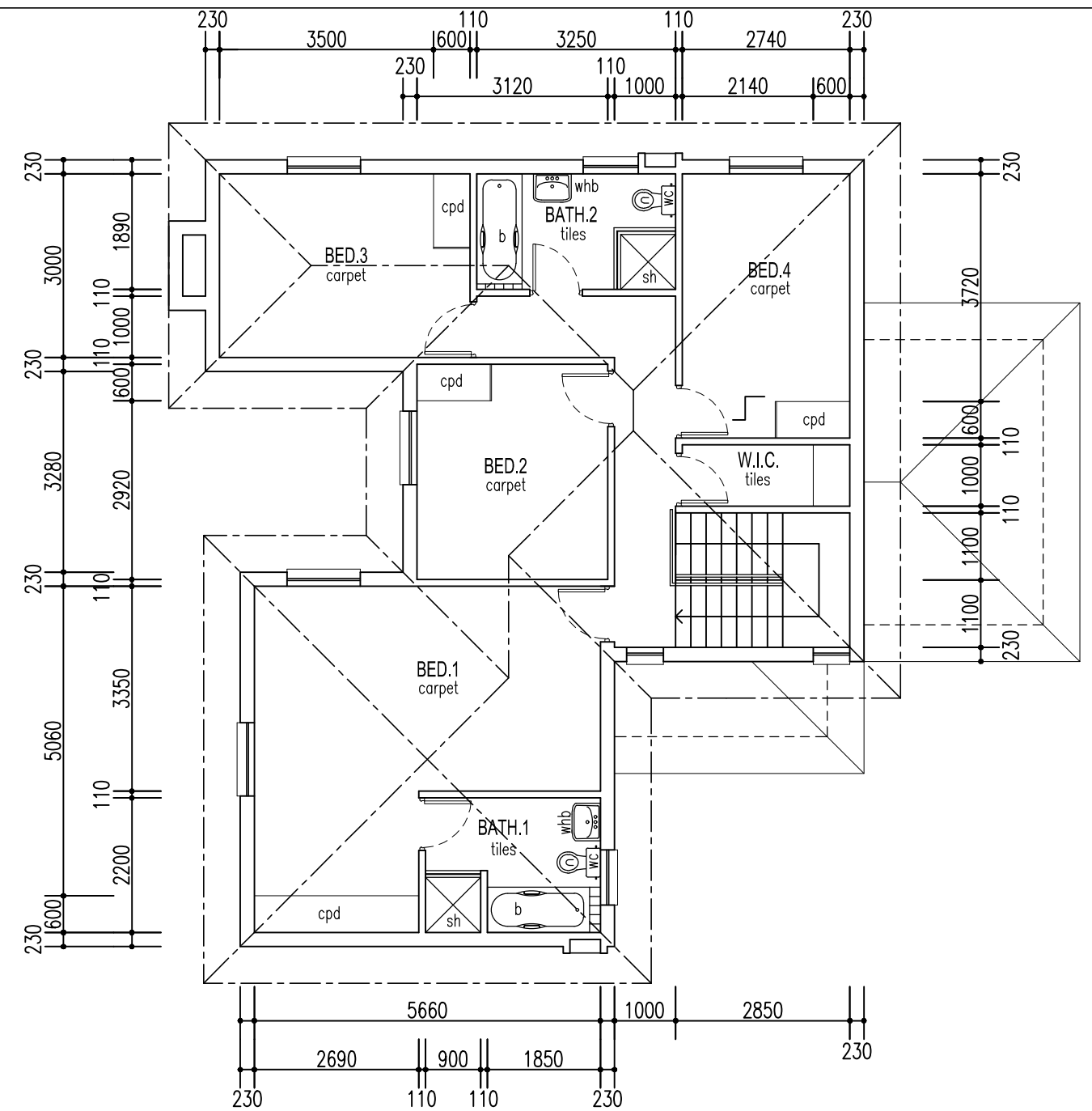

FIRST STOREY = 105,4sq.m.

DRAWING DESCRIPTION

SKETCH PLAN - TYPE F PLANS (West Entry)

PROJECT

PROPOSED NEW DEVELOPMENT FOR PARKRAND x19

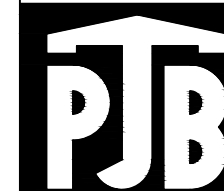

pieter bezuidenhout
architect
 reg. no. 7477

dwg. no.
4401

7 alice avenue
 comet
 boksburg

p o box 25820
 east rand
 1462

date: 22/07/2014

scale: 1:100

area: see plan

tel:- (011)892-3958
 fax:- (011)892-3958
 cell:- 082-458-4839
 e-mail:- pjbbez@pjb-architect.co.za
 web:- www.pjb-architect.co.za